

SECTION A - A' LOOKING EASTERLY
REF. PLATE R2B

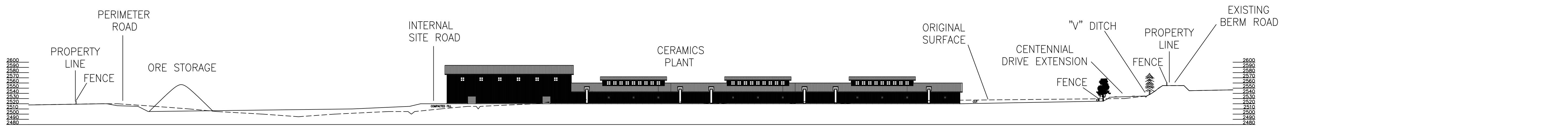

SECTION B - B' LOOKING NORTH
REF. PLATE R2B

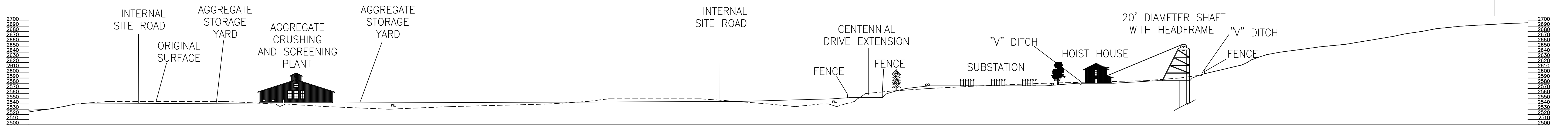

SECTION C - C' LOOKING NORTH
REF. PLATE R2B

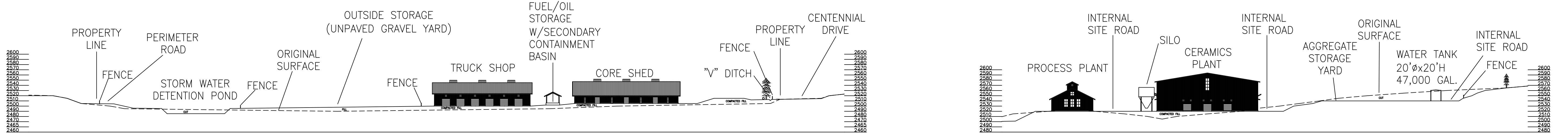

SECTION D - D' LOOKING NORTHERLY
REF. PLATE R2B

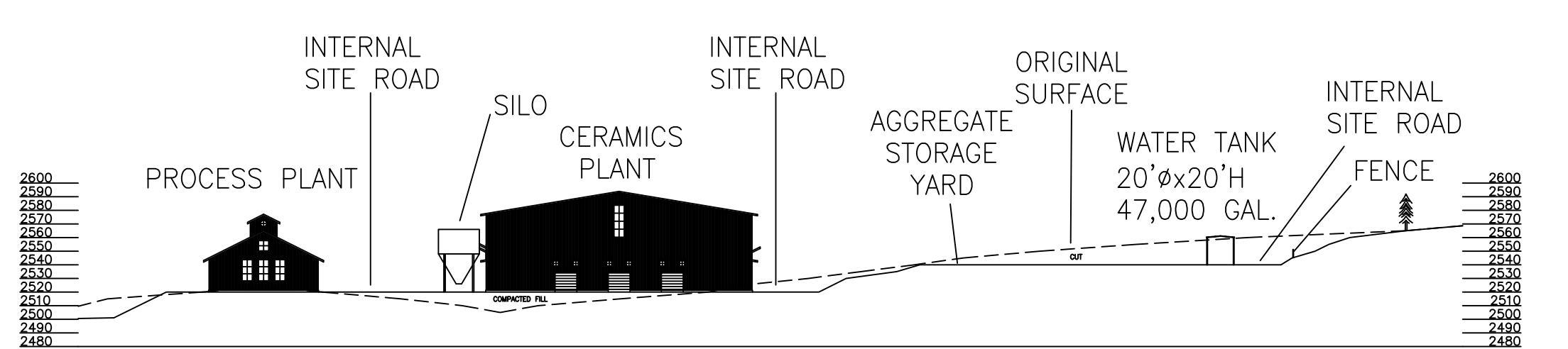

SECTION E - E' LOOKING EASTERLY
REF. PLATE R2B

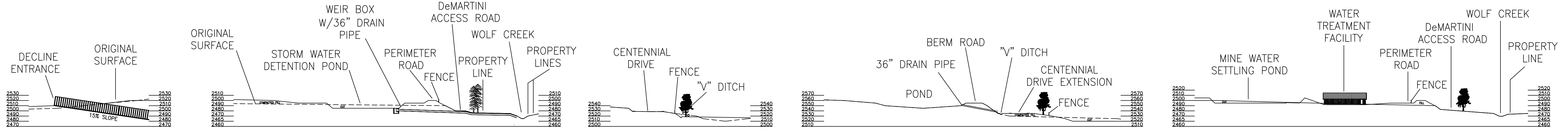

SECTION F - F' LOOKING NORTHERLY
REF. PLATE R2B

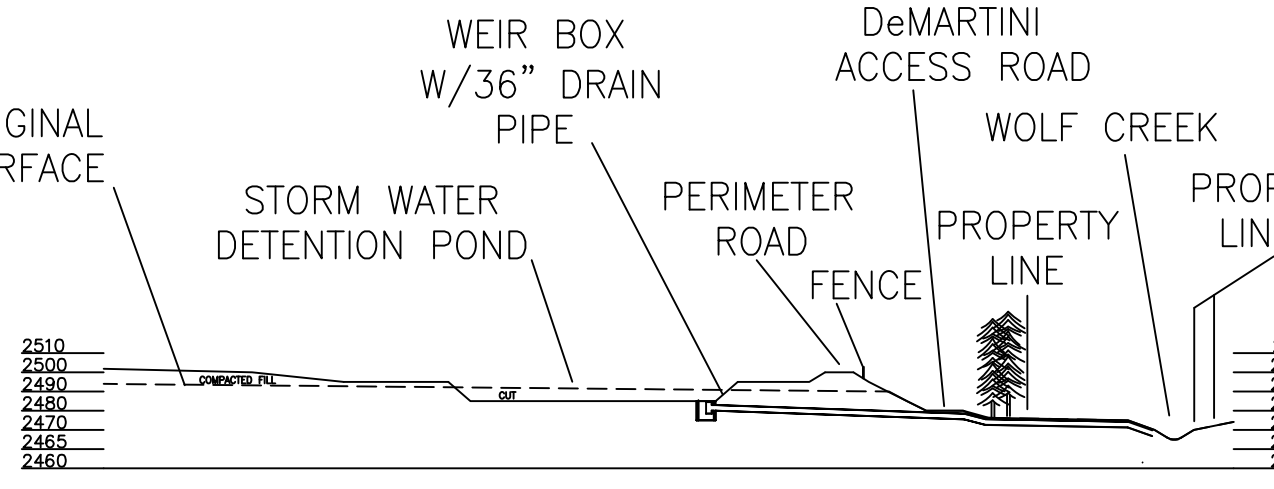

SECTION G - G' LOOKING WESTERLY
REF. PLATE R2B

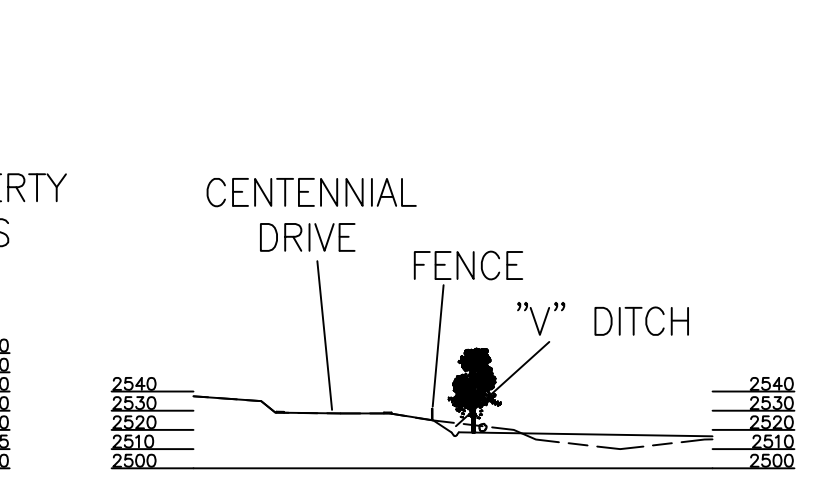

SECTION H - H' LOOKING SOUTHEAST
REF. PLATE R2B

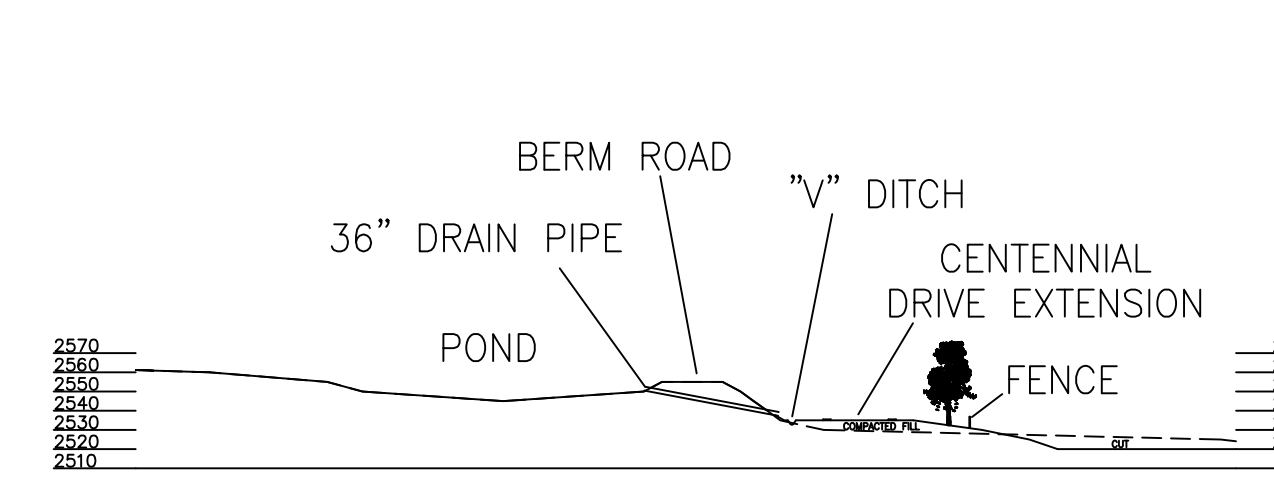

SECTION I - I' LOOKING SOUTHERLY
REF. PLATE R2B

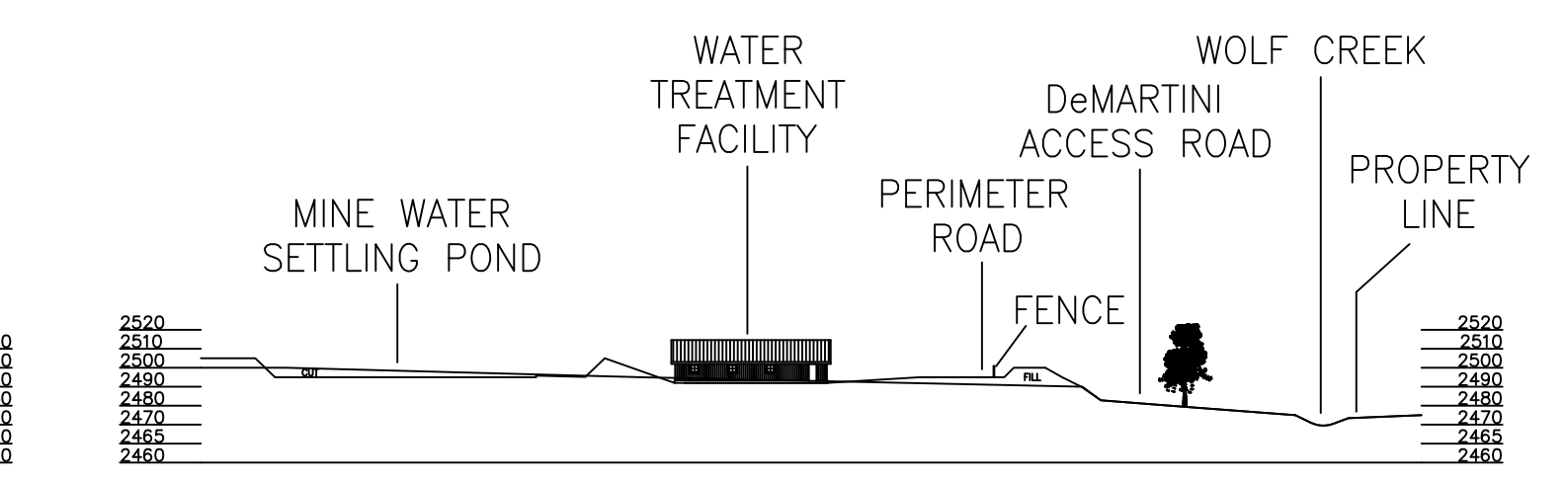

SECTION J - J' LOOKING WEST
REF. PLATE R2B

NO.	DATE	REVISIONS	BY	CHK
B	04-11	Issued For Permitting		
A	04-07	Issued For Permitting		

DRAWN:	DPH	PROJECT:	
DATE:	4-8-11	SCALE:	AS SHOWN
CHECKED:	PN	APPROVED:	DGW
DATE:	4-8-11	DATE:	4-8-11

Idaho-Maryland Mine Project
 Grass Valley, California

Cross Section of the Idaho-Maryland Site
R16-Rev2

PLATE:

NOTICE
 This document and the information shown thereon is confidential, and has been prepared for the exclusive use of Idaho-Maryland Mining Corporation (IMMC) and is intended solely for the use of IMMC. Any use of, and/or reliance on, this document or its contents by any party is at such party's sole and complete risk. By use of this document, recipients agree that IMMC shall not be held responsible or liable for any damages or claims (whatsoever or howsoever caused) arising from use of, or reliance on, this document. This drawing and/or the information contained herein shall not be copied, in whole or in part, without the prior written consent of IMMC. Copies of this document, in whole or in part and made for any use, shall include this note on each copy and on each subsequent copy.

4-8-11 IMMC Cross Section R16